

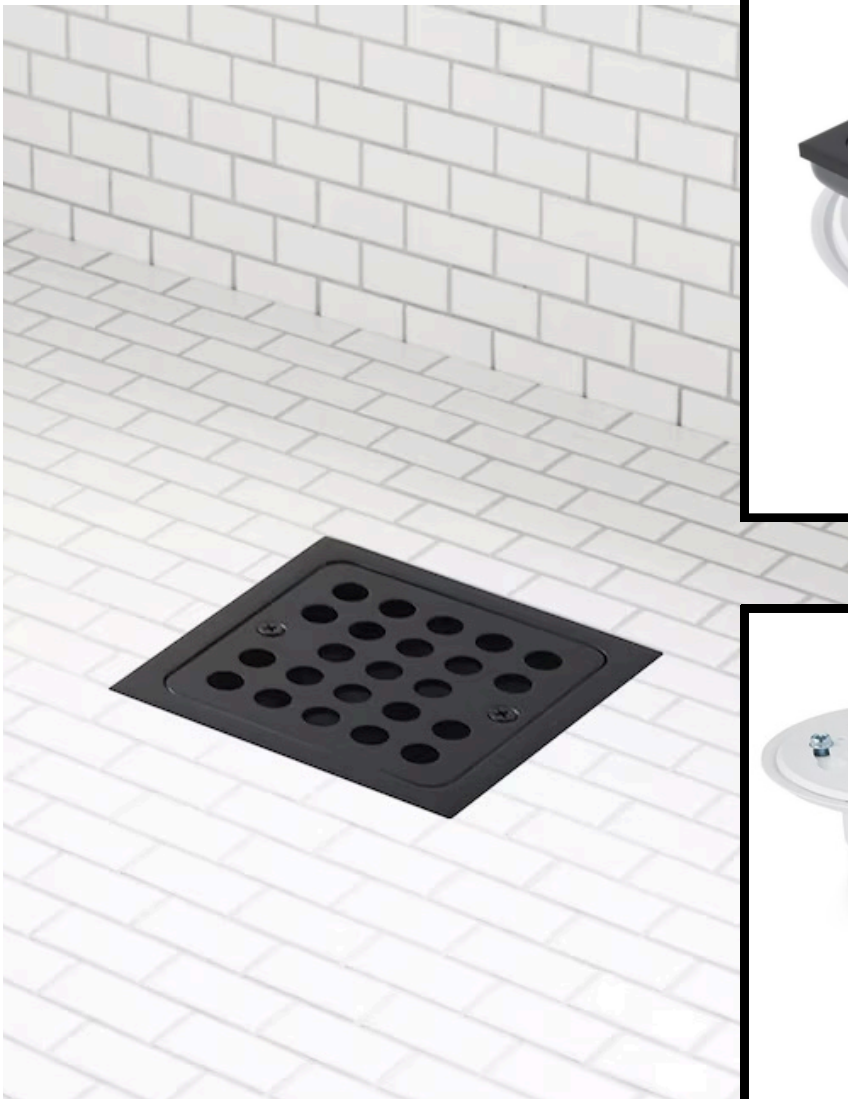

# Product Information Sheet

---

## 4-1/2" Square Shower Drain - SD4S01



# Product Specifications

**ASME:** ASME A112.18.2-2015

**Collection:** Menlo

**Drain Base Material:** Plastic

**Drain Grate Material:** Brass

**Grate Color Finish Category:** Blacks

**Length:** 4-1/2 in

**Adjustable:** Yes

**Construction:** Non-Membrane

**Drain Base Material Type:** PVC

**Fits Pipe Size:** 2 in - 3 in

**Grate Shape:** Square

**Outlet Type:** Push On

**CSA Certified:** CSA B125.2-15

**Drain Base Height:** 2-7/8 in

**Drain Base Width:** 6-1/8 in

**Grate Color Finish:** Matte Black

**IAPMO Listed:** No

**Proposition 65:**

**WARNING:** Cancer and Reproductive Harm –  
[www.P65Warnings.ca.gov](http://www.P65Warnings.ca.gov)

# Product Dimensions

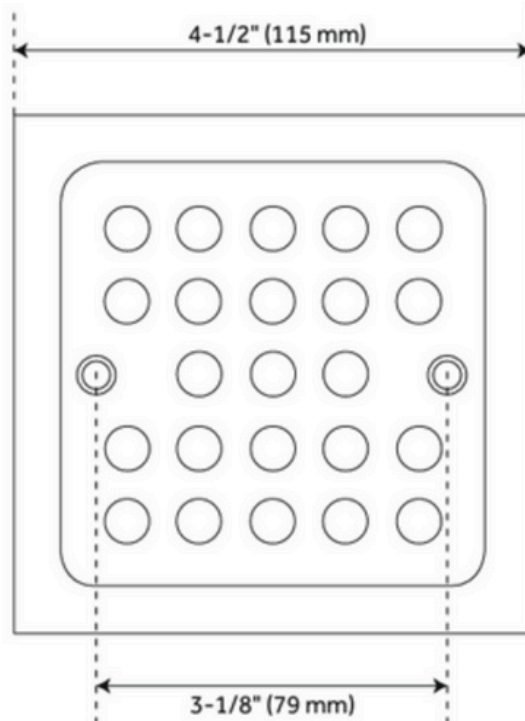
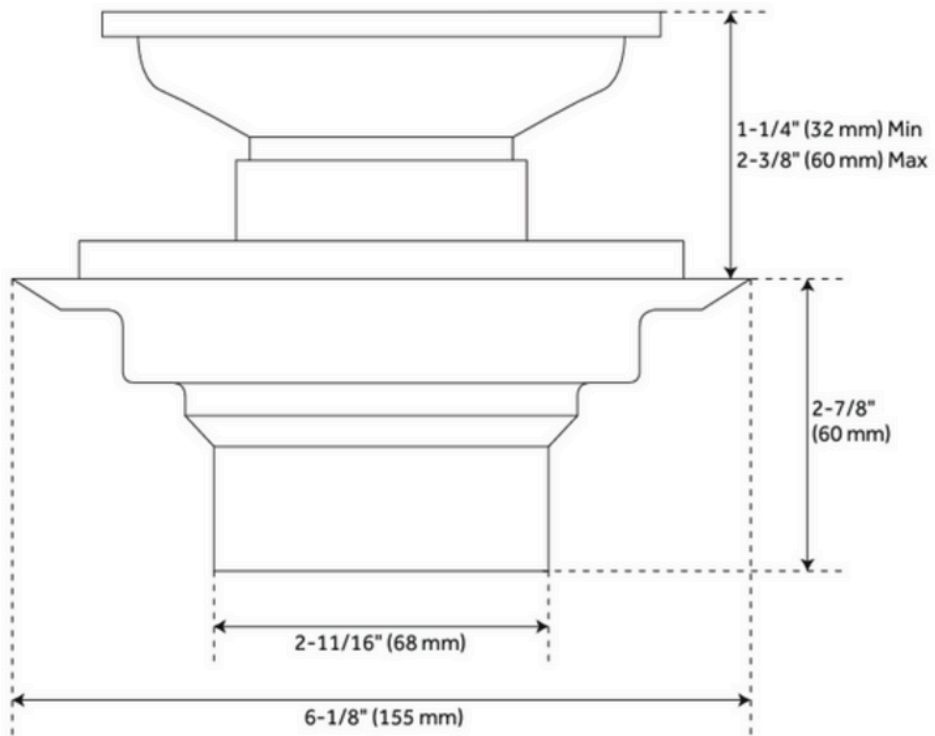

# Installation Instructions

## BEFORE YOU BEGIN

We recommend consulting a professional if you are unfamiliar with installing plumbing fixtures. We accept no liability for any damage to the to the plumbing, fixtures, fittings, or for personal injury during installation. Observe all local plumbing and building codes.

Unpack and inspect the product for shipping damage.

## GETTING STARTED

Ensure that you have gathered all the required materials that are needed for the installation. For these instructions, the shower framing should be constructed, and the flooring is plywood. The same applies to concrete flooring where the mortar bed is applied beneath the pan liner. The instructions apply to either PVC pan liner or CPE pan liner.

## TOOLS AND MATERIALS



Level



Drill



Pencil



PVC Glue



Mortar

## NOTE

You may require different, more specialized tools to install the shower drain and tiling of the shower floor.

## INSTALLATION

1. Staple building paper to the subfloor of the shower base. Disassemble the shower drain, set the screws, plate, ring and body aside. Also remove the screws from the collar to separate the collar from flange.

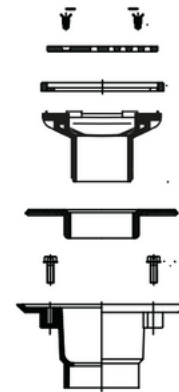

2. Glue the bottom piece to the drain pipe with appropriate cement. Partially screw the drain bolts into the drain piece and place a rag in the drain pipe to prevent mortar from falling into the drain.

3. Staple galvanized lath over the building paper, according to instruction of galvanized lath layer.

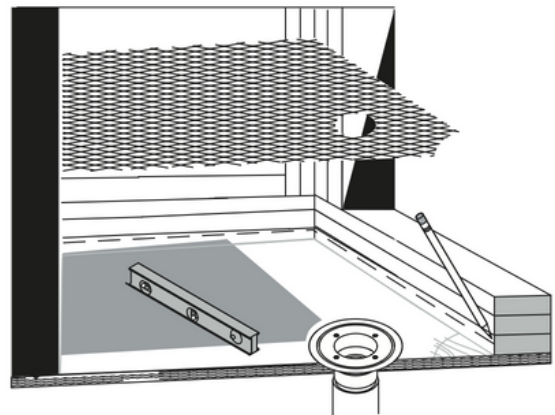

4. To apply mortar layer, trowel mortar over the galvanized lath from the outside of flange adapter up to the marked height of perimeter of shower base. Verify the slope of the mortar is even and fill in any low spots with mortar. Allow the mortar to cure overnight, according to instruction of mortar.

5. Place the waterproof membrane or shower pan liner on top of mortar. Prepare waterproof membrane or shower pan liner according to instruction of shower pan liner's application instructions. Cut away the shower pan liner at the screw location on the flange adapter and at the drain outlet.

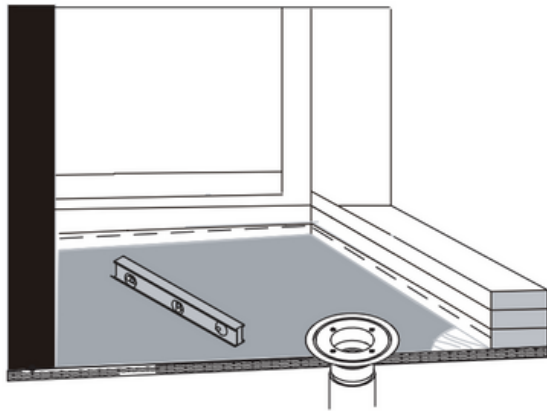

6. To assemble the drain, position the middle drain collar piece over the bolt holes. Install the bolts, tightening them evenly and firmly to create a watertight seal. Insert an inset into the drain, and then fill the shower base with water. Allow the water to sit overnight to check for leaks.

7. Assemble body and strainer of drain, set the ring on the strainer body. Set the plate inside the ring, and then secure the plate with two screws (provided).

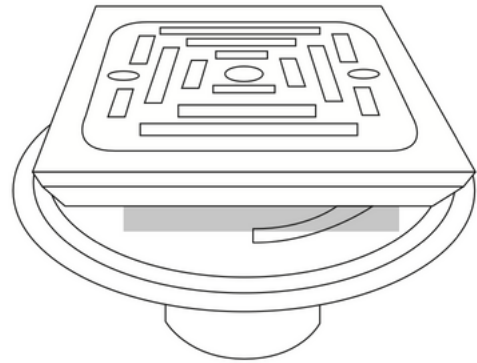

8. Apply tile layer, then install the tile to finish.